

545RFE 5 SPEED

45RFE - RWD/4WD FULLY ELECTRONIC - 4 SPEED

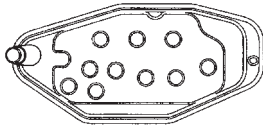

Oil Filter 45RFE
15 Bolt Pan
87700

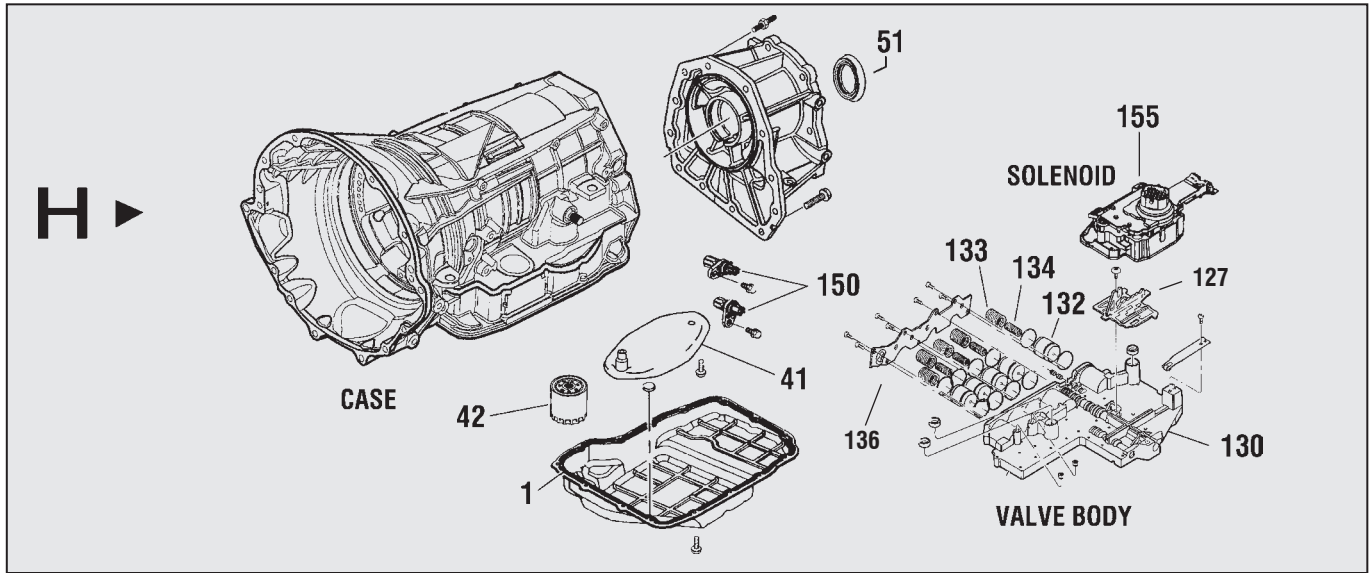

Cooler Return Filter
45RFE
87702

Grand Cherokee 4.7L V8 - 45RFE 99-Up
Durango - 45RFE 00-Up
Jeep - 545RFE 04-Up

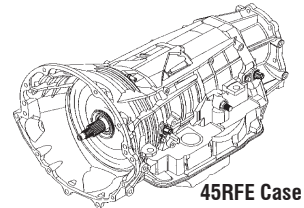

45RFE Case

REBUILDER KITS

| DESCRIPTION | QTY. | YEAR | DELUXE KIT | MASTER O/H KIT | LESS STEELS KIT | OVERHAUL KIT | GASKET & SEAL KIT |
|-------------|------|------|------------|----------------|-----------------|--------------|-------------------|
|-------------|------|------|------------|----------------|-----------------|--------------|-------------------|

To order Kits with all Borg Warner frictions, use a 'KB' prefix instead of the traditional 'K' prefix.

| | | | | | | | |
|----------------------------|---|-------|--|-------|----------|--------|--|
| Rebuilder Kits - 45RFE (1) | 1 | 99-Up | | K8700 | K8700-LS | K87900 | |
|----------------------------|---|-------|--|-------|----------|--------|--|

(1) Master Overhaul Kit and Less Steels Kit contain bonded piston and bonded retainer.

| ILL. | DESCRIPTION | QTY. | YEAR | PART NO. | REFERENCE NO. |
|------|-------------|------|------|----------|---------------|
|------|-------------|------|------|----------|---------------|

VALVE BODY KITS

| | | | | | |
|------|--|---|-------|-----------|-----------|
| N.I. | TRANSGO® | | | | |
| N.I. | Shift Kit® Prevents 2-3 Neutral / Limp & Slip Codes..... | 1 | 99-04 | K87908 | SK®45RFE |
| N.I. | Reprogramming Kit™ 4 / 5 Speeds - Heavy Duty | 1 | 99-04 | 45RFE-HD2 | 45RFE-HD2 |

MISCELLANEOUS GASKETS & SEALS

| | | | | | |
|------|---|---|-------|--------|-----------|
| 1H | Gasket - Pan - Fibre (Original is Silicone) | 1 | 99-Up | 13716F | N.L. |
| 3A | Seal - Pump Cover - Outer | 1 | 99-Up | 13559 | N.L. |
| 5A | Seal - Pump Cover - Inner | 1 | 99-Up | 13560 | N.L. |
| N.I. | Seal - Filter New | 1 | 99-Up | 13548 | 4799964AB |

CLUTCH PLATES

Order Frictions with 'B' prefix for Borg Warner brand, 'R' prefix for Raybestos brand. ('R' suffix for Raybestos Red)

| | | | | | |
|-----|------------------------------|---|-------|-------|------------|
| 20C | Friction - Underdrive | 4 | 99-Up | 87100 | 04799106 |
| 22C | Friction - Overdrive | 4 | 99-Up | 87102 | 04799114 |
| 24D | Friction - Reverse | 2 | 99-Up | 87104 | 04799757 |
| 26E | Friction - 2nd | 2 | 99-Up | 87106 | 04799244 |
| 28E | Friction - 4th | 3 | 99-Up | 87108 | 04799530 |
| 30G | Friction - Low/Reverse | 6 | 99-Up | 87110 | 04799461AB |

45/545RFE

45RFE - RWD/4WD FULLY ELECTRONIC - 4 SPEED

545RFE 5 SPEED

| ILL. | DESCRIPTION | QTY. | YEAR | PART NO. | REFERENCE NO. | |
|---|--|-------|-------|----------------|---------------|--------------|
| CLUTCH PLATES (Cont.) | | | | | | |
| 21C | Steel - Underdrive | 4 | 99-Up | 87101 | 04799105AB | |
| 23C | Steel - Overdrive..... | 3 | 99-Up | 87103 | 04799398AB | |
| 25D | Steel - Reverse..... | 1 | 99-Up | 87101 | 04799105AB | |
| 27E | Steel - 2nd..... | 2 | 99-Up | 87107 | 04799243 | |
| 29E | Steel - 4th..... | 3 | 99-Up | 87109 | 04799529 | |
| 31G | Steel - Low/Reverse..... | 6 | 99-Up | 87111 | 04799460 | |
| PRESSURE PLATES | | | | | | |
| 31C | Plate - Underdrive Pressure - 7.00..... | 1 | 99-Up | 87564 | 4799108AD | |
| | Plate - Underdrive Pressure - 3.60..... | 1 | 99-Up | 87564B | 4799109AD | |
| 32D | Plate - Overdrive/Reverse | 1 | 99-Up | 87563 | 4799116AB | |
| 33D | Plate - Reverse..... | 1 | 99-Up | 87562 | 4799121 | |
| 34E | Plate - 2nd..... | 1 | 99-Up | 87566 | N.L. | |
| 35E | Plate - 4th..... | 1 | 99-Up | 87567 | 4799533 | |
| 36G | Plate - Low/Reverse..... | 1 | 99-Up | 87565 | 4799667 | |
| FILTERS/FILTER KITS | | | | | | |
| Order Filter Kits with 'FK' prefix for Cork & Neoprene, 'FFK' prefix for Fibre. | | | | | | |
| N.I. | Filter Kit - 1 1/4" Inlet | 1 | 99-Up | FK87700 | N.L. | |
| 41H | Filter - Oil - 4WD - 1 1/4" Inlet..... | 1 | 99-Up | 87700 | 5013470AC | |
| | Filter - Oil - 2WD - 7/8" | 1 | 99-Up | 87700A | 4800029AA | |
| 42H | Filter - Cooler Return - Round..... | 1 | 99-Up | 87702 | 4799662 | |
| N.I. | Solenoid Screen - 1st Design (For Black Connector Solenoid)..... | 1 | 99-Up | 87713 | N.L. | |
| N.I. | Solenoid Screen - 2nd Design (For White Connector Solenoid)..... | 1 | 04-Up | 87713B | N.L. | |
| METAL CLAD SEALS | | | | | | |
| 50A | Housing - Front Pump | 1 | 99-Up | 87202 | 04617919 | |
| 51H | Housing - Extension..... | 1 | 99-Up | 16695C | 4531216AB | |
| 51H | Adapter - 4WD | 1 | 99-Up | 87205 | 4167929 | |
| BUSHINGS | | | | | | |
| N.I. | Bushing Kit | 1 | 99-Up | K87901 | N.L. | |
| SEALING RINGS/RING KITS | | | | | | |
| Order Sealing Rings with 'T' suffix for Teflon. | | | | | | |
| N.I. | Sealing Ring Kit..... | 1 | 99-Up | K87300 | N.L. | |
| THRUST WASHERS/NEEDLE BEARINGS | | | | | | |
| N.I. | Washer Kit..... | 1 | 99-Up | K87400 | N.L. | |
| HARD PARTS | | | | | | |
| Hard Parts may only require the base number for OEM/Aftermarket New. A "N" suffix may also be required or a "-R" suffix for remanufactured. Exceptions are listed individually. | | | | | | |
| NOTE: A separate column is provided to indicate a primary or specific brand/type. | | | | | | |
| ILL. | DESCRIPTION | BRAND | QTY. | YEAR | PART NO. | REFERENCE NO |
| 90A | Plate - Cover - Pump..... | | 1 | 99-Up | 87919 | 4799609 |
| 91A | Pump - Complete: | | | | | |
| | - w/ Shaft Hole..... | R | 1 | 99-02 | 87920 | 5072589AC |
| | - w/o Shaft Hole..... | R | 1 | 03-Up | 87920A | 5073004AB |
| 92B | Valve - Anti Drain Back - Input | | 1 | 99-Up | 87925 | 4799974AA |
| 93B | Input Hub - w/ Shaft (Reman Only w/ Shaft) | R | 1 | 99-Up | 87940 | 4799536AC |
| 94B | Spring - Overdrive Piston Return..... | | 1 | 99-Up | 87945 | 4799087 |
| 95B | Piston - Overdrive/Reverse | | 1 | 99-Up | 87941 | 4799645 |
| 96B | Retainer - Input | | 1 | 99-Up | 87943 | 4799648 |

545RFE 5 SPEED

45RFE - RWD/4WD FULLY ELECTRONIC - 4 SPEED

| ILL. | DESCRIPTION | BRAND | QTY. | YEAR | PART NO. | REFERENCE NO |
|-------------------------------------|---|-------|------|-------|-----------------|--------------|
| HARD PARTS (Cont.) | | | | | | |
| 97B | Piston - Underdrive - Bonded..... | | 1 | 99-Up | 87530 | 4799650 |
| 99B | Retainer - Underdrive - Bonded..... | | 1 | 99-Up | 87531 | 4799652 |
| 103D | Hub - Overdrive - w/ Shaft..... | | 1 | 99-Up | 87947 | 4799550 |
| 104D | Hub - Reverse..... | | 1 | 99-Up | 87948 | 4799556 |
| 106E | Housing - 2/4th Clutch..... | | 1 | 99-Up | 87949 | 4799498AB |
| 108E | Spring - 2nd Clutch - Piston Return..... | | 1 | 99-Up | 87950 | 4799521 |
| 110E | Spring - 4th Clutch - Piston Return..... | | 1 | 99-Up | 87953 | 4799527AB |
| 112F | Gear - Reaction - Internal..... | | 1 | 99-Up | 87968 | 4799501 |
| 113F | Gear - Reaction - Sun..... | | 1 | 99-Up | 87967 | 4799602 |
| 101C | Hub - Underdrive - w/ Shaft..... | | 1 | 99-Up | 87946 | 4799546 |
| 103D | Hub - Overdrive - w/ Shaft..... | | 1 | 99-Up | 87947 | 4799550 |
| 104D | Hub - Reverse..... | | 1 | 99-Up | 87948 | 4799556 |
| 106E | Housing - 2/4th Clutch..... | | 1 | 99-Up | 87949 | 4799498AB |
| 108E | Spring - 2nd Clutch - Piston Return..... | | 1 | 99-Up | 87950 | 4799521 |
| 110E | Spring - 4th Clutch - Piston Return..... | | 1 | 99-Up | 87953 | 4799527AB |
| 112F | Gear - Reaction - Internal..... | | 1 | 99-Up | 87968 | 4799501 |
| 113F | Gear - Reaction - Sun..... | | 1 | 99-Up | 87967 | 4799602 |
| 114F | Planet - Reaction w/ Reverse Sun Gear..... | | 1 | 99-Up | 87966 | 4799619AB |
| 115F | Planet - Reverse - (Center)..... | | 1 | 99-Up | 87956 | 4799503AB |
| 116F | Gear - Input - Sun..... | | 1 | 99-Up | 87958 | 4799586AB |
| 118F | Planet - Input - w/ Output Shaft..... | | 1 | 99-Up | 87951 | 4799500AB |
| 119F | Gear - Input - Internal..... | | 1 | 99-Up | 87952 | N.L. |
| 121G | Roller - Low w/ Races..... | | 1 | 99-Up | K87960 | 4799465 |
| 122G | Spring - Low/Reverse Piston Return..... | | 1 | 99-Up | 87955 | 4799640 |
| 125G | Housing - Low/Reverse..... | | 1 | 99-Up | 87957 | 4799635 |
| 127H | Plate TRS Cam (Solenoid)..... | | 1 | 04-Up | 87890 | 4799654AC |
| N.I. | Gears - Pump Body - Set of 3..... | | 1 | 99-Up | K87201 | N.L. |
| VALVE BODY - PREMIUM QUALITY | | | | | | |
| 130H | - 4 / 5 Speeds - Black / White Solenoid Design..... | | 1 | 99-Up | P87990 | N.L. |
| VALVE BODY COMPONENTS | | | | | | |
| 132H | Piston - Accumulator - Aluminum..... | | 5 | 99-Up | 72985 | 4446620 |
| | Piston - Accumulator - Bonded..... | | 5 | 99-Up | 72985R | 4446620AC |
| 133H | Spring - Accumulator - Large..... | | 5 | 99-Up | 72706 | 4471880 |
| 134H | Spring - Accumulator - Small..... | | 4 | 99-Up | 72706B | 4567575 |
| 136H | Plate - Valve Body - End..... | | 1 | 99-Up | 87834 | N.L. |
| N.I. | Spring TCC Accumulator - 5/Bag..... | | 1 | 99-Up | K87836 | N.L. |
| ELECTRICAL PRODUCTS | | | | | | |
| N.I. | Sensor - Line Pressure Control..... | | 1 | 99-Up | 20A-419 | 4799758AC |
| 150H | Sensor - Input/Output..... | | 2 | 99-Up | 20A-420 | 4799061AB |
| 155H | Solenoid Block - Black Connector - (Except 2004 Dodge)..... | | 1 | 99-04 | 31A-103 | 4799934AD |
| 155H | Solenoid Block - White Connector - (Except 2004 Jeep)..... | | 1 | 04-Up | 31A-103B | 5170877AA |
| NOTES | | | | | | |
| | | | | | | |
| | | | | | | |
| | | | | | | |
| | | | | | | |

45/545RFE